

MM92HR

Dual 9.2" Wide TFT LCD Pre-Mounted
Headrest Monitors

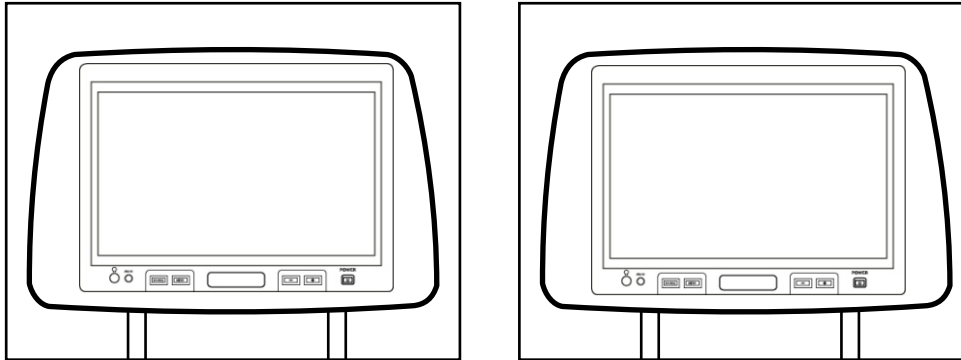

***Operation/Installation
Manual***

Important Notices

Installation of headrest products require careful planning and preparation. Be extremely careful of seats that have airbags built into them. Keep wiring away from any air bag wiring (usually identified by yellow connectors and yellow wire jackets). Damage to air bag wiring can result in personal injury to vehicle occupants. If you have any questions regarding wire routing or installation in a vehicle, please contact Audiovox Technical Support at 1-800-225-6074.

When connecting power and ground in a mobile video installation, insure that the ACC wire is fused at the point where it is connected to the vehicle ACC wiring. Failure to do so can result in damage to the vehicle if a short circuit develops between the vehicle connection point and the mobile video product.

An LCD panel and/or video monitor may be installed in a motor vehicle and visible to the driver if the LCD panel or video monitor is used for vehicle information, system control, rear or side observation or navigation. If the LCD panel or video monitor is used for television reception, video or DVD play, the LCD panel or video monitor must be installed so that these features will only function when the vehicle is in "park" or when the vehicle's parking brake is applied.

An LCD panel or video monitor used for television reception, video or DVD play that operates when the vehicle is in gear or when the parking is not applied must be installed to the rear of the driver's seat where it will not be visible, directly or indirectly, to the operator of the motor vehicle.

MM92HR System

The MM92HR system consists of two headrests each with a 9.2" LCD monitor. An additional DVD player (Audiovox AVD400A or MMDV5 or similar) is required in order to view DVD videos on this system. Alternatively, a gaming system can be used as a video input to play video games. In either case, it is recommended that a video amplifier (such as Audiovox VA100) be used to eliminate video signal loss which can result in poor picture quality.

In addition, 2-channel wireless IR (Infra-Red) headphones (Audiovox IR2CHS or similar) may be purchased to allow listening to the system without wired headphones.

Quick Start Guide

1. Turn on the video source (DVD player, game, etc.).
2. Press the Power button on the monitor.

Note: When the DVD player or source is turned on, it will automatically turn on the headrest monitor if the monitor is set to AV1 input.

3. Press the AV button to view the video source. (If there is no video displayed or video source selected, the monitor will turn off.)
 - a. AV1 source is the DVD player, game, etc.
 - b. AV2 is the AV2 input on the front of the monitor next to the headphone jack. Use the supplied adapter to input a video game or other video source.
4. When using the optional wired headphones, plug the headphones into the headphone jack on the front of the unit.
5. When using the optional 2-channel (A/B) wireless headphones, each headphone has an A/B switch on it. The monitor can be set to broadcast on channel A (2.3MHz/2.8MHz), or channel B (3.2MHz/3.8MHz. (Refer to the Monitor Operation section to set the Infrared transmitter to either channel A or channel B.)

MONITOR CONTROLS AND INDICATORS

Control Function Descriptions for Monitor M1 and M2

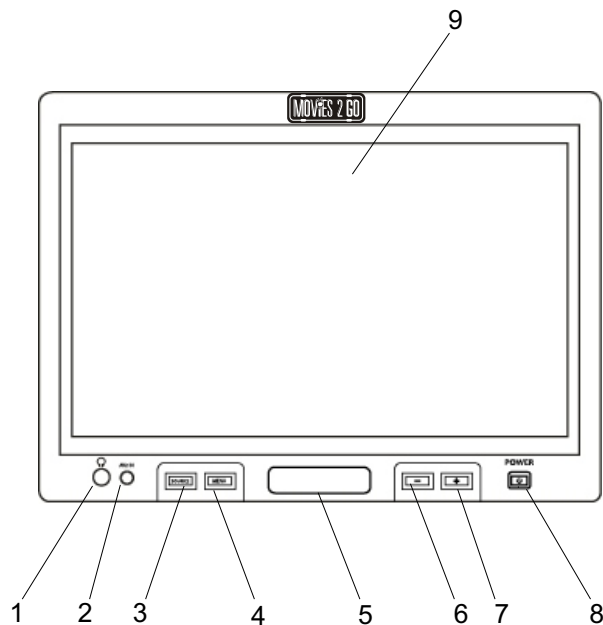

M1 / M2 Panel Control

1. Wired Earphone Jack
2. Audio/Video (AV2) Input Jack
3. SOURCE Button
4. MENU Button
5. Infrared (IR) Receiver/Transmitter
6. Audio Level Decrease/Cursor Down (-) Button
7. Audio Level Increase/Cursor Up (+) Button
8. POWER Button
9. TFT LCD Monitor

REMOTE CONTROL OPERATION

Battery Installation

To replace the battery in the Remote Control, perform the following procedure:

1. Place the Remote Control face down on a flat surface. Hold the Remote Control in place using one hand and with the other hand insert a fingernail into the groove of the spring catch (A in Step 1); insert thumbnail into the Battery Holder groove (B in Step 1) and slide out Battery holder.
2. Install "CR2025" Lithium Battery in the holder as shown in Step 2.
3. Slide the Battery Holder back into the remote control until it clicks in place as shown Step 3.

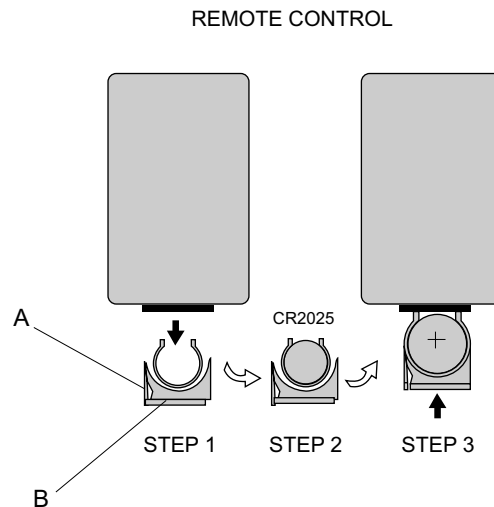

REMOTE CONTROL FUNCTIONS

* Function control is available on both the headrest monitor and remote control.

NOTE: To control the individual units (M1 Monitor / M2 Monitor) point remote directly at appropriate monitor and press the **POWER** button.

1. **POWER** Button: Press this button to apply power to the M1 and M2 monitor.
2. **INPUT** Button: When pressed, selects AV1 or AV2 input source for display.
3. **Volume Increase/Menu Cursor** Button: During normal play, increases audio volume. In menu mode, moves cursor up/right to desired function.
4. **Escape (ESC)** Button: Press to exit menu function.
5. **Volume Decrease/Menu Cursor** Button: During normal play, decreases audio volume. In menu mode, moves cursor down/left to desired function.
6. **MENU** Button: Press to display list of menu items.

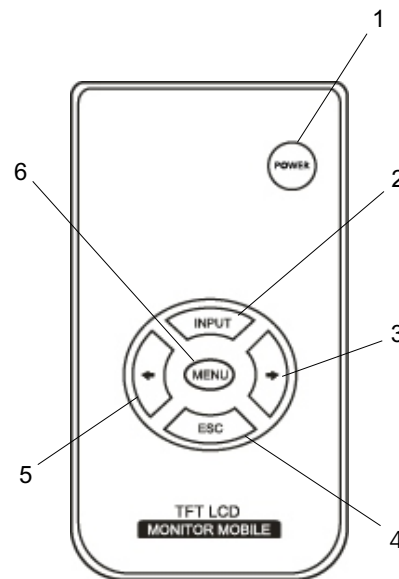

MM92HR SYSTEM OVERVIEW

- 1) The MM92HR is a versatile audio / video system which includes two pre-mounted headrest monitors. Each can accept an Audio / Video input to either the AV1 or AV2 inputs.
- 2) The M1 Monitor is comprised of a 9.2" TFT LCD monitor that allows the user to select from AV1 and AV2 sources. The M1 monitor has a built-in infrared audio transmitter for use with optional two-channel wireless headphones.
- 3) The M2 monitor is comprised of a 9.2" TFT LCD monitor that allows the user to select from AV1 and AV2, sources. The M2 monitor has a built-in infrared audio transmitter for use with optional two channel wireless headphones.
- 4) The monitors will show all of the functions with the comprehensive On Screen Display (OSD).
- 5) The optional IR Headphone sets (P/N IR2CHS) have an A-B switch that allow the users to select the audio from either the M1 (CH A) or the M2 (CH B).
- 6) The M1 and M2 Monitors will accept an audio / video input through either the AV2 input (located on the MM92HR front panel) or the AV1 input via the monitor cable. The audio / video device could be a DVD player, video game system, video camera, or other input device.

MONITOR OPERATION

Menu Functions

When the MENU button is pressed on the monitor or the remote control, the On Screen Display (OSD) functions are accessible in conjunction with the Left (⇐) and right (⇒) buttons on the remote control or the + and - buttons on the headrest monitor. The following OSD functions are available:

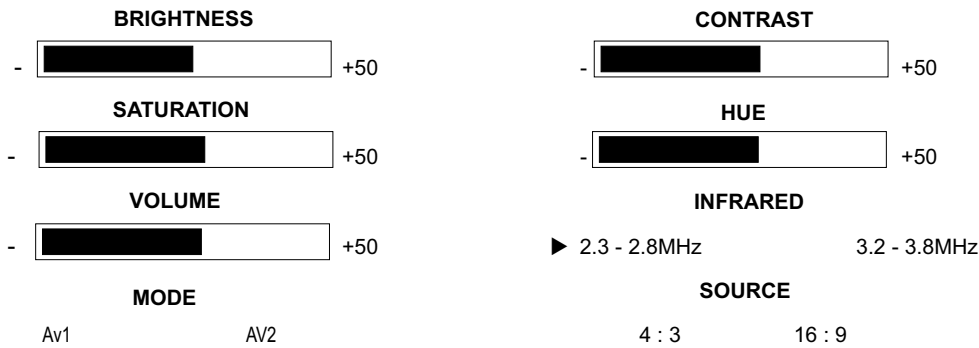

MM92HR HEADREST INSTALLATION

Installing the headrest monitor(s) is straightforward and requires minimum effort. If you are unsure of the installation process after reading these instructions, you may want to have this product installed by a professional. To install the headrest monitor, proceed as follows:

- 1) Release the existing headrest and pull it straight up until it clears the back of the seat.
- 2) Note the distance between the steel tubes of the headrest just removed and adjust the monitor headrest tubes together or apart as shown until they match this dimension.

Note: If internal seatback sleeve diameter is too big, insert the 12mm or 14mm sleeves into the existing sleeves before installing the monitor headrest assembly.

- 3) Guide the monitor headrest cable into and through the seat sleeves tubes while inserting the monitor headrest tubes into the seat sleeves. At the back of the seat, under the seat fabric, grasp the headrest monitor cable and pull it down, avoiding any twisting or kinks. It may be necessary to cut fasteners at the bottom of the seat to access the cables.
- 4) Mate the headrest monitor cable with the monitor cable assembly (AV input and power) as shown below.
- 5) Route the monitor cable assemblies to the video source (DVD, Game etc.).
- 6) It is recommended that a video amplifier (Audiovox VA100) be wired in line between the DVD player or game and headrest AV inputs. This will prevent signal degradation of the video signal.
- 7) Connect the black wires to a good vehicle ground.
Connect the red wires to an ACC (switched 12VDC) source. Make sure that all power wires are fused.



Adjust tubes together or apart

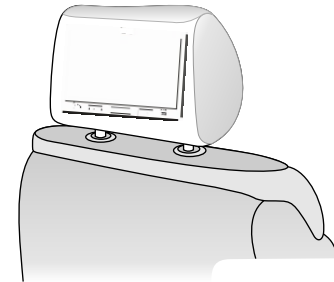
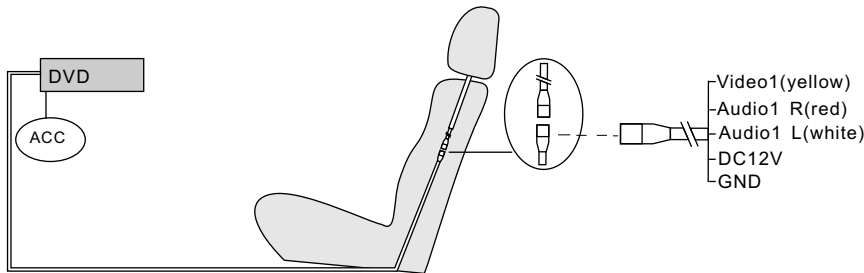

TROUBLESHOOTING

PROBLEM	SOLUTION
IR sensor inoperative	<ul style="list-style-type: none">• Verify that the battery in the remote is fresh.• Verify that the remote sensor eye is not obstructed.
Disc won't play	<ul style="list-style-type: none">• Check the type of disc you put into disc tray. This monitor accepts only DVDs, audio CDs and MP3s.• Both the unit and the disc are coded by region. If the regional codes don't match, the disc can't be played.
Play starts, but then stops immediately	<ul style="list-style-type: none">• The disc is dirty. Clean it.• Condensation has formed. Allow external player to dry out.
No sound or distorted sound	<ul style="list-style-type: none">• Make sure external DVD is connected properly. Make sure all cables are securely inserted into the appropriate jacks.• If you are using the IR headphones, make sure you turn on the IRT power, and make sure the IR headphones are set to the correct channel (A or B), and that the corresponding headrest IR transmitter is set to the correct channel.
OSD Displays "Incorrect Disc Format"	<ul style="list-style-type: none">• Disc loaded backwards, turn disc over.



CAUTION

1. Keep the monitor clean and dry.
2. Always seek qualified personnel to perform repairs. Never attempt your own repairs.
3. Do not drop the monitor or expose to strong impacts.
4. Do not expose to direct sunlight for extended periods of time.

HEADREST MONITOR SPECIFICATIONS

1. Type :	9.2" Wide TFT LCD Monitor
2. Mounting	Posts Adjustable From 4" apart to 8" apart
3. AV Input	1 Set Wired AV1 Input, AV2 Input Jack (1/8")
4. IR Transmitter	Channel A: 2.3MHz (Left), 2.8MHz (Right) Channel B: 3.2MHz (Left), 3.8MHz (Right)
5. Resolution	800 RGB X 480
6. Power Source	+12 VDC
7. Power Consumption	30W For 2 Monitors
8. Operating Temperature	32°F ~ 140°F (0°C ~ +60°C)
9. Storage Temperature	-4°F ~ 176°F (-20°C ~ +80°C)
10. Video Display System	NTSC/PAL (Selectable)
11. Wired Headphone	
Audio Output	0.03W @ 32 ohm
13. Environmental Humidity	< 90%



12 MONTH LIMITED WARRANTY

Applies to Movies To Go Mobile Video Products

AUDIOVOX ELECTRONICS CORP. (the Company) warrants to the original retail purchaser of this product that should this product or any part thereof, under normal use and conditions, be proven defective in material or workmanship within 12 months from the date of original purchase, such defect(s) will be repaired or replaced with reconditioned product (at the Company's option) without charge for parts and repair labor. A game controller, if supplied, is similarly warranted for ninety (90) days.

To obtain repair or replacement within the terms of this Warranty, the product is to be delivered with proof of warranty coverage (e.g. dated bill of sale), specification of defect(s), transportation prepaid, to the Company at the address shown below.

This Warranty does not extend to the elimination of externally generated static or noise, to correction of antenna problems, to costs incurred for installation, removal or reinstallation of the product, or to damage to digital memory cards, discs, speakers, accessories or vehicle electrical systems.

This Warranty does not apply to any product or part thereof which, in the opinion of the Company, has suffered or been damaged through alteration, improper installation, mishandling, misuse, neglect, accident, or by removal or defacement of the factory serial number/bar code label(s). THE EXTENT OF THE COMPANY'S LIABILITY UNDER THIS WARRANTY IS LIMITED TO THE REPAIR OR REPLACEMENT PROVIDED ABOVE AND, IN NO EVENT, SHALL THE COMPANY'S LIABILITY EXCEED THE PURCHASE PRICE PAID BY PURCHASER FOR THE PRODUCT.

This Warranty is in lieu of all other express warranties or liabilities. ANY IMPLIED WARRANTIES, INCLUDING ANY IMPLIED WARRANTY OF MERCHANTABILITY, SHALL BE LIMITED TO THE DURATION OF THIS WRITTEN WARRANTY. ANY ACTION FOR BREACH OF ANY WARRANTY HEREUNDER INCLUDING ANY IMPLIED WARRANTY OF MERCHANTABILITY MUST BE BROUGHT WITHIN A PERIOD OF 24 MONTHS FROM DATE OF ORIGINAL PURCHASE. IN NO CASE SHALL THE COMPANY BE LIABLE FOR ANY CONSEQUENTIAL OR INCIDENTAL DAMAGES FOR BREACH OF THIS OR ANY OTHER WARRANTY, EXPRESS OR IMPLIED, WHATSOEVER. No person or representative is authorized to assume for the Company any liability other than expressed herein in connection with the sale of this product.

Some states do not allow limitations on how long an implied warranty lasts or the exclusion or limitation of incidental or consequential damage so the above limitations or exclusions may not apply to you. This Warranty gives you specific legal rights and you may also have other rights which vary from state to state.

Audiovox Electronics Corporation, 150 Marcus Blvd., Hauppauge, N.Y., • 1-800-645-4994

128-6429F

THIS PAGE LEFT BLANK INTENTIONALLY

